

The image features a solid orange background with a repeating pattern of white hexagons. Each hexagon contains a stylized, circuit-like or molecular structure. The letters "RIT" are printed in a white, serif font in the upper left corner.

RIT

Undergraduate  
Research Symposium

2024

Thursday, August 1, 2024

8:00 a.m. to 4:00 p.m.

Campus Center and Student Alumni Union - RIT Campus

## General Agenda

Start Time	End Time	Event	Location
8:00 a.m.	9:00 a.m.	Check-In & Continental Breakfast	SAU 1300
9:00 a.m.	9:45 a.m.	Welcome Remarks & Keynote Speaker	Ingle Auditorium SAU 1250
10:00 a.m.	11:00 a.m.	Oral Presentations Session 1	CPC/SAU Conference Rooms
10:30 a.m.	11:30 a.m.	Poster Presentation Session 1 & Coffee Break	Fireside Lounge SAU 1550
11:30 a.m.	12:30 p.m.	Oral Presentations Session 2	CPC/SAU Conference Rooms
11:30 p.m.	1:30 p.m.	Open Lunch	SAU 1300
1:45 p.m.	3:00 p.m.	Oral Presentations Session 3	CPC/SAU Conference Rooms
3:00 p.m.	4:00 p.m.	Poster Presentations Session 2 & Coffee Break	Fireside Lounge SAU 1550

\*Breakfast and Lunch for those registered by 7/24/24

Maps

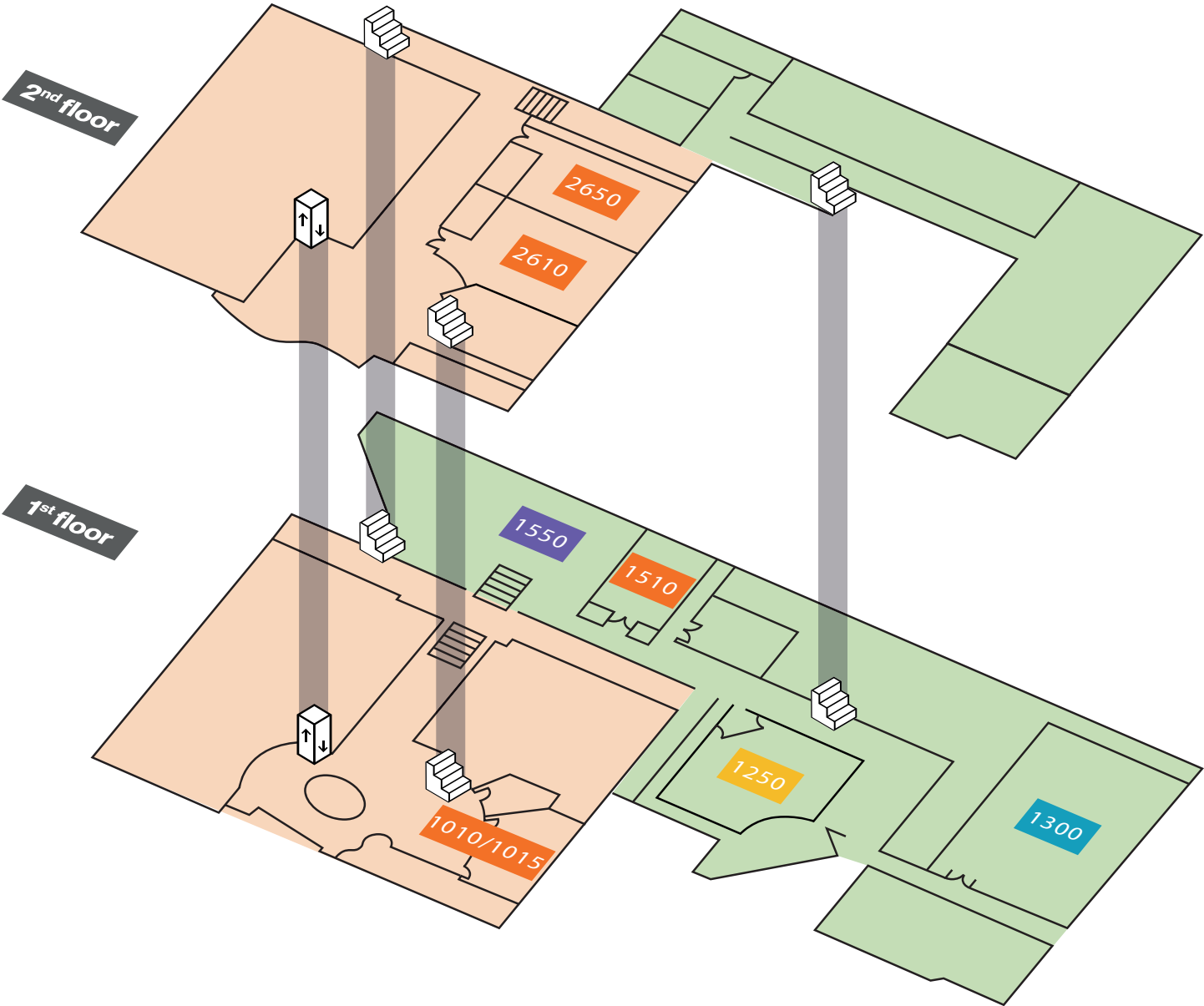

Campus Center  
 1010/1015  
 2610 –Bamboo Room  
 2650 –Bamboo Room

Student Alumni Union  
 1510–1829 Room  
 1550–Fireside Lounge  
 1250–Ingle Auditorium  
 1300–Davis Room  
 Skalny Room - Lower level

Stairs  
 Elevator  
 Oral Presentation  
 Breakfast/Lunch  
 Poster Presentation  
 Keynote Speaker

## Keynote Speaker



### Roberta Benedict

#### **Battery technology scientist and RIT alumna Roberta DiLeo Benedict opens the 2024 Undergraduate Research Symposium**

One of RIT's elite scholars, Roberta DiLeo Benedict, will open the 2024 Undergraduate Research Symposium as keynote speaker. She'll discuss her path from undergraduate research to becoming an experienced researcher of lithium-ion battery development, one of the key technology growth areas in the country today.

While an undergraduate at RIT, Benedict received the prestigious Barry M. Goldwater Scholarship, the premier undergraduate award for students interested in pursuing careers in mathematics, the natural sciences or engineering.

She'd use the award and her interest in physics to springboard coursework, research and co-op opportunities with RIT's NanoPower Research Laboratories. Benedict's research involving the chemical vapor deposition synthesis of carbon nanotubes has been published in multiple science and technology journals and included in conference proceedings. She'd go on to receive a dual degree in physics and material science in 2008, then complete her doctoral degree in microsystems in 2012.

Benedict's experiences are wide-ranging including roles as a research scientist for Eastman Kodak to an adjunct professor at RIT. In 2019 she began work with local lithium-ion battery research and manufacturing company Celtec Technologies Inc. There, she is a research scientist and focused on energy storage materials, and ensuring the efficiency, safety and performance of battery technologies that will impact today's connected and integrated environment.



## CPC-1010/1015

### Education Applications I

Time	Researcher	Advisor	Title
10:00	Alissa Mitelman	Mike Foster	Faculty and Student Perceptions: Computational Tools in Stats
10:15	Tecora Tisdale	L. Kate Wright	A characterization of biology students' drawings for exam preparation
10:30	Brett Boyle	Ben Zwickl	Using social cognitive career theory to understand physics subfield choice
10:45	Igor Polotai	Tamar Carroll	The RIT Iceberg: A Study of Collegiate Student Folklore and Traditions

### 10:30 - 11:30 Poster Presentations Session 1 and Coffee Break (Fireside Lounge SAU 1550)

### Education Applications II

11:30	Evan Leopold	Ashish Agrawal	Engineering Faculty Perception of Math Courses
11:45	Ella Stuck	Jessica Contreras	BSI Benchmark Project: Developing ASL Proficiency Norms
12:00	Becca Bogstad	Christian Cammarota	Building Computational Literacy with Polygenic Inheritance Exploration
12:15	Mateo Cacheriro	Ben Zwickl	Developing an online tool to collect cognitive maps of student reasoning

### 11:30 - 1:30 Lunch (Davis Room SAU 1300 )

### Education Applications III

1:45	Annabelle Li	L. Kate Wright/ Dina Newman	Probing Students' Understanding of Genetics Using a Card-choosing Task
2:00	Afnaan Qureshi	Katie Terezakis	Framing Ethics in STEM Research: Conceptualize, Operationalize, & Interact
2:15	Olivia Furr	Christina Goudreau Collison	Exploring how signs affect hearing student attitudes in organic chemistry
2:30	Willow Rose	Marjorie Prokosch	How Does Mental Imagery Relate to Environmental Cognition and Behavior
2:45	Matt Lawler	Ben Zwickl	Analysis of student generated causal maps using network analysis techniques

### 3:00 - 4:00 Poster Presentations Session 2 and Coffee Break (Fireside Lounge SAU 1550)

## 1829 Room

	<b>Time</b>	<b>Researcher</b>	<b>Advisor</b>	<b>Title</b>
Astronomy and Astrophysics Applications I	10:00	Karina Bryant	Andrew Robinson	Emission Lines Signatures of Runaway Supermassive Black Hole
	10:15	Eli Wolochow	Michael Zemcov	Investigating Atmospheric Noise in the TIME Instrument
	10:30	Leo Coons	Jeyhan Kartaltepe	Formation of Milky-Way Type Galaxies at High Redshift
	10:45	Dylan Filosa	Candice Fazar	Analyzing persistence from SPHEREx detector data
10:30 - 11:30 Poster Presentations Session 1 and Coffee Break (Fireside Lounge SAU 1550)				
Astronomy and Astrophysics Applications II	11:30	Zachary Knutson	Andrew Robinson	Light Echo Modeling of Active Galactic Nuclei: The Dusty Transition Region
	11:45	Mathew Oaks/ Justin Morales	Yosef Zlochower	Cosmic Dance: Orbital Anomalies in Binary Black Hole-Star Simulations
	12:00	Christine Cheng	Joel Kastner	A StargateVR Search for Open Star Clusters with Gaia DR3
11:30 - 1:30 Lunch (Davis Room SAU 1300 )				
Astronomy and Astrophysics Applications III	1:45	Lilly Blanton	Mike Zemcov	Calibrating for Nonlinearity in the CIBER-2 Detectors
	2:00	Joey Root	Jeyhan Kartaltepe	Examining Emissions Lines of Galaxies from JWST Using PyQSOFit
	2:15	Elizabeth Adamson	Jason Nordhaus	How did a planet get so close to a white dwarf?

3:00 - 4:00 Poster Presentations Session 2 and Coffee Break (Fireside Lounge SAU 1550)

## Bamboo-2650

	<b>Time</b>	<b>Researcher</b>	<b>Advisor</b>	<b>Title</b>
Mechanical and Chemical Systems and Processes	10:00	Esmond Lau/ Moni Chavez	Patricia Iglesias Victoria	Choline Amino Acids Protic Ionic Liquids as neat lubricants and additives
	10:15	Adrian Heldt	Akhtar Khan	Stochastic Approximation in Inverse Problems
	10:30	Claire Dantzerward	Ke Xu	Electric Field Facilitated Catalysis of a Fluorogenic Click Reaction
	10:45	Steve Liang	Ke Xu	Oriented External Electric Field Catalysis of Fluorogenic Click Reaction

10:30 - 11:30 Poster Presentations Session 1 and Coffee Break (Fireside Lounge SAU 1550)

### Microsystems Applications I

10:00	Dale Janezic	Ivan Puchades	Characterization and High Frequency Testing of Graphene Transistors
10:15	Liam Almekinder	Jeremy Cody	Preparations of Polymethine Dyes
10:30	Joniel Yege	Ke Xu	Preparation and Transfer of Large-Area 2D Materials for Device Fabrication

11:30 - 1:30 Lunch (Davis Room SAU 1300)

3:00 - 4:00 Poster Presentations Session 2 and Coffee Break (Fireside Lounge SAU 1550)

## Bamboo-2610

	<b>Time</b>	<b>Researcher</b>	<b>Advisor</b>	<b>Title</b>
Healthcare Applications I	10:00	Leah Robinson	Crista Wadsworth	Doxycycline resistance in Neisseria commensals: An in vitro study
	10:15	Ethan Adkins	George Thurston	Production and isolation of beta crystallin proteins in the eye lens
	10:30	Nikhi Boggavarapu	Stefan Schulze	Comparative Analysis of Proteomics Data from Neisseria gonorrhoeae
	10:45	Katie Miller	Renata Rezende Miranda	Synthesis of Conjugation Inhibitor Analogs to Prevent Bacterial Conjugation

10:30 - 11:30 Poster Presentations Session 1 and Coffee Break (Fireside Lounge SAU 1550)

Healthcare Applications II	11:30	Victoria Krauze	Satish Kandlikar	Experimental Design for Simulation of Cardiac Ablation
	11:45	Mary Emily Visingardl	Renata Rezende Miranda	Novel Conjugation Inhibitors to Help Combat Antibiotic Resistance
	12:00	Amanueal Bezie	Larry Villasmil	The Effect of the Nature of Air Supply / Continuous Air Source and Portable
	12:15	James Campbell	Celeste Sangiorgio	Developing and Testing a Game to Impact Dating Attitude
	12:30	Brendan Cappon	Satish Kandlikar	Impact of Myocardial Perfusion on Transient Thermal Profile during Ablation

10:30 - 1:30 Lunch (Davis Room SAU 1300)

Biological Applications	1:45	Noah Courtney	L. Kate Wright	Seeing Success: Unveiling the Use of Visual Models in Biology Exams
	2:00	Georgette Trekell	Stefan Schulze	Confocal Laser Scanning Microscopic Analysis of P. aeruginosa Biofilms
	2:15	Meredith Michetti	L. Kate Wright	Students Struggle to Connect Genetics Concepts: Genes and Gene Expression

3:00 - 4:00 Poster Presentations Session 2 and Coffee Break (Fireside Lounge SAU 1550)

Poster Presentations

SAU 1550

	Poster	Researcher	Advisor	Title	Time
College of Engineering Technology	100	Angel Ponce de Leon	Carlos Diaz Acosta	Thermoformed packaging made of multi-layered biodegradable materials	3:00 - 4:00 p.m.
	101	Riley Rohauer	MD Ahasan Habib	SEM Characterization of Alginate, Gelatin and TONFC Bioinks	10:30 - 11:30 a.m.
	102	TiasJah Terry	Bilge Altay	Plant Based PFAS Free Alternatives for Packaging Applications	10:30 - 11:30 a.m.
	103	Perrin Woods	MD Ahasan Habib	Developing a UV-Curing Enabled Nozzle Mount for a Custom 3D Bioprinter	3:00 - 4:00 p.m.
College of Health Sciences	104	Alin Ali	Robert Osgood	Investigation of Factors Affecting Streptococcus pneumoniae Biofilm Formati	3:00 - 4:00 p.m.
	105	Crystal Lee	Robert Osgood	Developing a Tri-Plex qPCR Assay for Streptococcus sobrinus Serotypes	10:30 - 11:30 a.m.
College of Liberal Arts	106	Olivia Bechdel	Evelyn Brister	Projecting Species Composition of Forested Wetlands After EAB Invasion	3:00 - 4:00 p.m.
	107	Logan Brownell/ McKenzie Wolfe/ Victoria Curtis/ Gabrielle Koehler/ Genevieve Wright	Caroline DeLong	Handedness in Olive Baboons During a Cognitive Task and Natural Behaviors	10:30 - 11:30 a.m.
	108	Natalie Fornieri	Dustin Haraden	The Fellowship of the ZZZs: An Unexpected Journey into Sleep, Substance use	3:00 - 4:00 p.m.
	109	Romiere Horace	Rebecca Houston	Aggression, Impulsivity, and Cluster B Personality Disorder Symptoms	10:30 - 11:30 a.m.
	110	Robert Murdock	Matt Hoffman	PEvaluating the movement of plastic debris in tributaries and riparian zones	3:00 - 4:00 p.m.



## SAU 1550

	Poster	Researcher	Advisor	Title	Time
College of Liberal Arts	111	Evangelina Mack/Emily Funk	Jessica Hardin	Dialysis Modalities in Rochester	10:30 - 11:30 a.m.
	112	Zale Piepho	Kaitlin Stack Whitney	Campus Bees and Bee-Friendly Landscaping Practices	3:00 - 4:00 p.m.
	113	Paige Woodall	Matthew Dye	Towards Valid and Reliable Socioeconomic Status Measurement in Deaf Studies	10:30 - 11:30 a.m.
NTID	114	Lyn Eaton	Kierstin Muroski	Utterance Boundaries in Interpreting: Investigating Student Use of Prosody	3:00 - 4:00 p.m.
	115	Alison Hansen	Elizabeth Ayers	Empowering Access: Designing Inclusive Patient Portals	10:30 - 11:30 a.m.
	116	Cathleen Jolly	Elizabeth Ayers	The Role of Humor in Healthy Relationships Among Deaf Couples	3:00 - 4:00 p.m.
	117	Emma Kane	Peter Hauser	Deaf Bilinguals ASL and English Lexical Knowledge	10:30 - 11:30 a.m.
	118	Yasmine Lee	Mariam Paracha	Evaluate Mobile Health App to Enhance Accessibility for DHH Users	3:00 - 4:00 p.m.
	119	Ellie Rose McCullagh	LeeAnne Valentine	Understanding How a Lack of Sex Education Impacts D/HH LGBTQ + Students	10:30 - 11:30 a.m.
	120	Isabella McGuire	Peter Hauser	Understanding American Sign Language Fingerspelling & Number Comprehension	3:00 - 4:00 p.m.
	121	Sawyer Nicastro	Dyl Levenson	Integrating Handshape Recognition Functionality for Navigation Apps	10:30 - 11:30 a.m.
	122	Rhiannon Wagner	Tiffany Panko	Analyzing deaf and hard-of-hearing communication in prehospital medicine	3:00 - 4:00 p.m.

## SAU 1550

	<u>Poster</u>	<u>Researcher</u>	<u>Advisor</u>	<u>Title</u>	<u>Time</u>
College of Science	123	Fletcher Austin	Julie Thomas	Forming Phages: Understanding Protein Cleavages in Virus Formation	10:30 - 11:30 a.m.
	124	Henry Badt	Shima Parsa	Flow conditioning for controlled fluid testing characteristics	3:00 - 4:00 p.m.
	125	Erin Brown	Andre Hudson	Effects of Bacterial Colonization On Polypropylene Biodegradation	10:30 - 11:30 a.m.
	126	Luke Chrzan/ Alex Gregor	Karen Braun	Vineyard Imaging for NDVI Estimation System	3:00 - 4:00 p.m.
	127	Christina Ciko	Lea Vacca Michel	Enhancing the Immunogenicity of Extracellular Vesicle-based Vaccines Again	10:30 - 11:30 a.m.
	128	Maria Ciko	Emiliano Brini	Predicting Protein-Peptide Binding Affinities via MELD x MD simulations	3:00 - 4:00 p.m.
	129	Jaclyn Conley	Hans Schmitthenner	Assembly of Targeted Molecular Imaging Agents for Breast Cancer	10:30 - 11:30 a.m.
	130	Halley Deme	Lea Michel	Using CloudPoint to Quantify Effects of Mutations on Bovine I <sup>3</sup> B Crystallin	3:00 - 4:00 p.m.
	131	Ian Empen	Charles Bachmann	Modeling created wetland soil organic matter with UAS hyperspectral imagery	10:30 - 11:30 a.m.
	132	Micah Ford	Carmody McCalley	Effect of the Emerald Ash Borer on Carbon Cycling in Forested Wetlands	3:00 - 4:00 p.m.
	133	Elena Fuentes Solano	Dr. Schulze	Impact of Protein Glycosylation on Pseudomonas aeruginosa Biofilms	10:30 - 11:30 a.m.
	134	Greg Givotovsky	Nathan Eddingsaas	Analysis of surface water microplastics in tributaries of Lake Ontario	3:00 - 4:00 p.m.
	135	Chris Gravina	Kara Maki	Predicting Particle-Laden Droplet Shapes on Heterogeneous Surfaces	10:30 - 11:30 a.m.

## SAU 1550

	Poster	Researcher	Advisor	Title	Time
College of Science	136	Olivia Gustafson	Michael Heagy	Synthesis of catechol appended zinc tetra(4-carboxyphenoxy)phthalocyanine	3:00 - 4:00 p.m.
	137	Kurt Hahn	Shima Parsa	Reactive Transport in Microfluidics Porous Media	10:30 - 11:30 a.m.
	138	Mimi Harrison	Jeyhan Kartaltepe	Identifying Massive Quiescent Candidate Galaxies with COSMOS-Web	3:00 - 4:00 p.m.
	139	Hailey Jordan	Christina Goudreau	Exploring awareness of ASLcore Among COS RIT faculty and Interpreters	10:30 - 11:30 a.m.
	140	Kiera Kelly	Nishant Malik	Analysis of a Coevolving Networks-based Opioid Epidemic Model	3:00 - 4:00 p.m.
	141	Bryden Kerchoff	Eli Borrego	Oxylipins During Maize Kernel Germination	10:30 - 11:30 a.m.
	142	Michael Kostrna	Ephraim Agyingi	Modeling COVID-19 Transmission Dynamics with Wastewater Surveillance Data	3:00 - 4:00 p.m.
	143	Brett Kruse	Shima Parsa	Quantifying Flow in a Water Channel for the Study of Particle Sedimentation	10:30 - 11:30 a.m.
	144	Mia Kushner	Lea Vacca Michel	Bacterial Extracellular Vesicles as a Diagnostic Tool for Sepsis	3:00 - 4:00 p.m.
	145	Noah Manning	Richard O'Shaughnessy	Reanalysis of GWTC-3 to Compare Next Generation Waveform Models	10:30 - 11:30 a.m.
	146	Kristna Mannix	Dr.Robinson	Constraining a Sample of Active Galactic Nuclei to Identify Rogue SMBH	3:00 - 4:00 p.m.
	147	Caroline McDevitt/Molly Regan	Crista Wadsworth	Silent Evolution: Ciprofloxacin-selected Resistance in Commensal Neisseria	10:30 - 11:30 a.m.
	148	Katrina McMaster	Jeyhan Kartaltepe	Examining Galaxy Morphologies with JWST Images	3:00 - 4:00 p.m.
	149	Kaya Miller	Andrew Robinson	Identifying Runaway Supermassive Black Holes Via Broad Emission Line Shapes	10:30 - 11:30 a.m.
	150	Francesca Molee	Elena Lopez Peredo	Stress Response in Algae from Retention/Non-Retention Sites	3:00 - 4:00 p.m.

# Undergraduate Research Symposium

## SAU 1550

	<b>Poster</b>	<b>Researcher</b>	<b>Advisor</b>	<b>Title</b>	<b>Time</b>
College of Science	151	Olivia Mollo	Carmody McCalley	The Impact of the Emerald Ash Borer on Bird Habitat and Species Composition	10:30 - 11:30 a.m.
	152	Julia Neumann	Elle Barnes	Forested Wetlands and Emerald Ash Borer Die-Off: Impact on Amphibian Specie	3:00 - 4:00 p.m.
	153	Jasmine Nichols	Lea Michel	Broad Spectrum Antibiotics and the Pal-TolB System	10:30 - 11:30 a.m.
	154	Griffin Pileski	Hans Schmitthenner	Synthesis of Alanine-Based Self-Assembling High-Relaxivity Contrast Agents	3:00 - 4:00 p.m.
	155	Eva Reilly	Suzanne Oâ€™™ Handley	Nudix Diadenosine Polyphosphatases from Mycobacteria	10:30 - 11:30 a.m.
	156	Nikita Robinson	Lea Vacca Michel	Investigating Bacterial Extracellular Vesicles as a Biomarker for Sepsis	3:00 - 4:00 p.m.
	157	Sophie Routenberg	Christy Tyler	Impacts of Herbivore Exclusion on Plant Diversity and The Nitrogen Cycle	10:30 - 11:30 a.m.
	158	Maleah Sena	Elena Lopez Peredo	Exploring Stress Responses in a Suite of Green Algae in the Scenedesmaceae	3:00 - 4:00 p.m.
	159	John Seyler	Renata Rezende Miranda	Assessing the Cellular toxicity of novel Tanzawaic Acid-derived COINs	10:30 - 11:30 a.m.
	160	April Soule	Susan Pagano	Physiological Recovery in Swainson's Thrushes During Migratory Stopovers	10:30 - 11:30 a.m.
	161	Jen Sundstrom	Tony Wong	Assessing Class Size Effects on Student Success in Gateway Math Courses	10:30 - 11:30 a.m.
	162	Serena Tuytschaevers	Renata Rezende Miranda	Computational Assessment of Novel Bacterial Conjugation Inhibitors	3:00 - 4:00 p.m.
	163	Roselyn Veras	Jeyhan Kartaltepe	Mapping Cosmic Mergers: Galaxy Merger Rates and Stellar Mass Insights	10:30 - 11:30 a.m.
	164	Elsa Waidelich	Christy Tyler	Accumulation of anthropogenic debris in tributary riparian zones	3:00 - 4:00 p.m.
	165	Chenxin Wang	Stefan Schulze	Impact of Glycosylation on Bacterial Motility & Antibiotic Resistance	10:30 - 11:30 a.m.

## SAU 1550

	<u>Poster</u>	<u>Researcher</u>	<u>Advisor</u>	<u>Title</u>	<u>Time</u>
College of Science	166	Ella Watts	Ben Zwickl	Formation of students' interests in quantum technology across STEM majors	3:00 - 4:00 p.m.
	167	Mya Wynn	Lea Michel	Elucidating the intermolecular interactions of Gamma B Crystallin Proteins	10:30 - 11:30 a.m.
	168	Jacob Ziegler	Ke Xu	Linear conductivity control of EDLTs for neuromorphic computing	3:00 - 4:00 p.m.
	169	Dylan Darling	Michael Pierce	X-Ray Scattering of Eye Lens Proteins	10:30 - 11:30 a.m.
College of Computing and Info Sciences	170	Orion DiLorenzo	Saniat (John) Sohrawardi	Preventing Misinformation Dissemination through Deepfake Detection Software	3:00 - 4:00 p.m.
	171	Claire Fischer	Matthew Wright	Analyzing Burst Characteristics of SSH Network Traffic	10:30 - 11:30 a.m.
	172	Abdul Moiz	Linwei Wang	Predicting Heart Failure Rehospitalization with In-Home Cardiac Monitoring	3:00 - 4:00 p.m.
College of Engineering	173	Noah Donner/ Jason Lonneville	Jing Zhang	GaN FinFET Development Study	10:30 - 11:30 a.m.
	174	Ross Janezic	Dorin Patru	Automated Amplifier Calibration for Photonic POC Reader	3:00 - 4:00 p.m.
	175	Elliot Kurz/ Vincent Micheli	Dorin Patru	Custom Emulation and Test Controller for a Programmable Lease Cache	10:30 - 11:30 a.m.
	176	Kenneth Loehr	Qian Xue	Effects of Asymmetric Glottal Insufficiency on the Function of Vocal Folds	3:00 - 4:00 p.m.
	177	Kaitlyn Lockhart	Steven Day	Bioturbation of Microplastics in Freshwater Sediment	10:30 - 11:30 p.m.



## SAU 1550

	<b>Poster</b>	<b>Researcher</b>	<b>Advisor</b>	<b>Title</b>	<b>Time</b>
College of Engineering	178	Alyssa Rzasa	Karin Wuertz Kozak	CRISPR modified MSC-derived EVs for the treatment of IVD cells.	3:00 - 4:00 p.m.
	179	Drew Schacke	Dorin Patru	CSTARS Post Mission Analysis and Testing	10:30 - 11:30 a.m.
	180	Joey Streib	Jason Kolodziej	Design of Variable Resistance Devices for a Mock Circulatory Loop	3:00 - 4:00 p.m.
	181	Jessica Tarrach/ Kylina Comerford	Steven Weinstein	Thin Film Coatings of Novel 2D Polymers	10:30 - 11:30 a.m.
	182	Zachary Thomas/ Cody Thompson	Rui Liu	Investigation of the canonical view of objects in virtual reality	3:00 - 4:00 p.m.
	183	Joseph Vazquez	Howard Tu	Solid-Electrolyte Mechanical Properties for All-Solid-State Batteries	10:30 - 11:30 a.m.
	184	Nino Zipser	Isaac Bernabe Perez Raya	Liquid Hydrogen Storage and Multiphase Flow in Cryogenic Propellant Tanks	3:00 - 4:00 p.m.
	185	Taylor Stanley/ Cornelius O'Leary	Steven Day	Miniaturizing and Enhancing Reliability of a Mag-Lev Centrifugal Blood Pump	10:30 - 11:30 a.m.
	186	JJ Laux	Dumindu Premachandra/ Michael Heagy	TiO <sub>2</sub> /MPC-cat thin film PHJ from a sol-gel approach via spin-coating applic	3:00 - 4:00 p.m.
College of Business	187	Ryan Haver	Hao Zhang	Corporate Risk Disclosure and Stock Trading: Evidence from Corporate Filings	10:30 - 11:30 a.m.